



Connection Solutions
4Workplaces

simon
connect

**general
catalogue**
2011 - 2012



K45 TELEBLOCK

The Simon K45 TELEBLOCK provides a solution for any connection, adapting to any type of furnishings.



WiFi area



Offices



Hotels



Auditoriums



Meeting rooms



DIRECT SNAP-FIT

With all necessary materials

The K45 Teleblock section is supplied with one blind cover, two half-mechanism blind plates, metal divider plate, insertion ring (with push-pull or gas cylinder), screw thread for fitting and all necessary hardware for installation.

(The cover and the trim frame are supplied separately.)



Mechanisms, electrical sockets and plates from page 72

Automatic elevation



Maximum integration



Open

When connected and folded it integrates perfectly into the furniture, hiding the connections. It acts as trunking when closed.

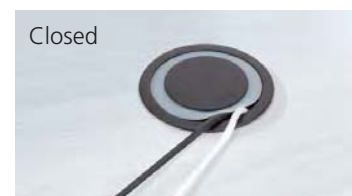

Closed

Entry plates for lower access



< Plates with connector

Quick connection.
Connectors and Patch cords on page 138

K19/14
< Tube inlet

K19/14
< Gland

TC250/0
Cable > organiser

K121A/14
K121B/14
< Quick Connection

K18/14
< Quick Connection

K305A/14
< Quick Connection

K20/14
< Cable inlet

Matt chrome-plated	Aluminium	Pure white Ral 9010	Graphite grey Ral 7021
/31	/8	/9	/14

K45 TELEBLOCK FOR CONFIGURATION



KTL202	For 2 K45 usable mechanisms with manual elevation
KTL203	For 3 K45 usable mechanisms with manual elevation
KTL204	For 4 K45 usable mechanisms with manual elevation
KTLE205	For 5 K45 usable mechanisms with automatic elevation
KTL205	For 5 K45 usable mechanisms with manual elevation
KTL206	For 6 K45 usable mechanisms with manual elevation

N
New
product



KTLA1 /14 /31

Cover and trim frame

K45 TELEBLOCK WIRED AND ASSEMBLED



KTLE216U	Includes 2 graphite-grey Schukos, 2 red Schukos and 2 RJ45 Cat. 6 UTP. Automatic elevation. *
KTLE215U	Includes 2 graphite-grey Schukos, 2 red Schukos and 2 RJ45 Cat. 5e UTP. Automatic elevation. *
KTL215U	Includes 2 graphite-grey Schukos, 2 red Schukos and 2 RJ45 Cat. 5e UTP. Manual elevation. *
KTL216U	Includes 2 graphite-grey Schukos, 2 red Schukos and 2 RJ45 Cat. 6 UTP. Manual elevation. *
KTL212-PACK CUISINE	Includes 2 graphite-grey Schukos and 1 electric patch cord 3x2.5 mm with Schuko plug. Manual elevation.

N
New
product

N
New
product



KTLA1 /14 /31

Cover and trim frame

* With 2 electrical patch cords of 3x2.5 mm², 2 m, Schuko plug and 2 voice and data 2 m.

Installation accessories

Electric connection patch cords. See page 141
Patch cords V&D. See page 132



K66

90° positioner for K45 plates on columns or vertical sections.
See page 80



TS10 /8 /14

Cable outlet with Ø 102 mm for desk or raised floor

Spare parts for K45 TELEBLOCK Automatic elevation

N
New
product



KTLA2

Gas cylinder for automatic elevation

Installation tools



H114

Cutting crown with 114 mm diameter



H114U

Spindle for H114 hole saw

Spare parts for K45 TELEBLOCK



KTLA3

Push-Pull module for manual elevation



KTLA4

Table attachment mount for manual elevation



KTLA5

Upper lock



KTLA6

Lower lock

Configuration example



	Quantity	Ref./Finish	Description
Covering	1	KTLE205	K45 Teleblock for 5 usable K45 mechanisms, automatic elevation
	1	KTLA1/14	Cover and trim frame, graphite
Electrical sockets and plates	2	K11/8	K45 electrical socket, Schuko, quick terminal connection, aluminium
	1	K100B/8	K45 plate 1 mechanism with 1 VGA female connector, aluminium. Screw connection
	1	K66	90° positioner for K45 VDM plates
	1	KB8096U/8	Angled K45 plate with dust protector and 2 RJ45 Cat. 6 UTP, aluminium
	1	K20/8	K45 cable input plate with retainer included, aluminium
	1	TC250/0	Cable organiser Ø 25 mm and 2 m length

Technical information

Plastic parts manufactured using thermoplastic, self-extinguishing, halogen-free materials, which prevent flames from spreading during a fire and guarantee low toxicity in the event that any smoke is released.



K45 TELEBLOCK

- Product designed according to the Safety Requirements of Directive 2006/95/EC (Low Voltage) through standard UNE-EN-60.670.
- CE marked product.
- IP protection level: 4x.
- The recommended temperature range during installation is: -5°C to + 60°C.
- The maximum temperature during construction work is + 60°C.
- Manufactured in Anodised Aluminium.

K45 TELEBLOCK manual elevation

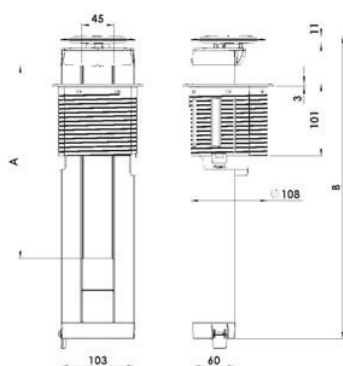

References	No. of modules K45	Dimensions A B		Space measurement
KTL202	2	89	242	Ø 114
KTL203	3	135	287	Ø 114
KTL204	4	180	332	Ø 114
KTL205	5	225	377	Ø 114
KTL206	6	269	422	Ø 114

K45 TELEBLOCK automatic elevation

Ref. KTL205

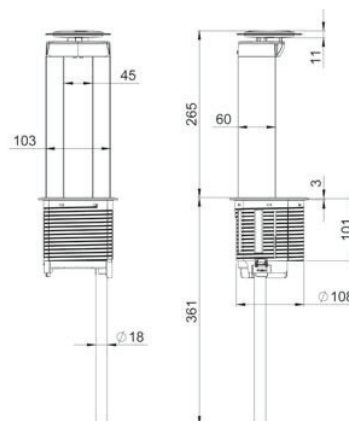

Ref. KTLA1/..

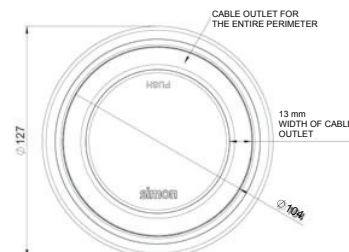

Spare parts

Ref. KTLA2

Gas cylinder for automatic TELEBLOCK elevation



Technical data of gas cylinder:
 Ø 18 – 8 mm
 Piston stroke: 271 mm
 Locking force: 50 N
 Temperature range: -30° C – 80° C

Ref. KTLA5

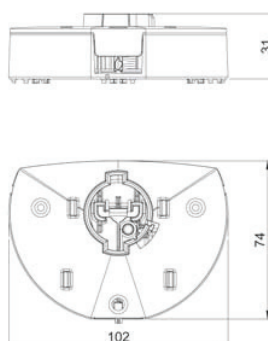

Ref. KTLA6

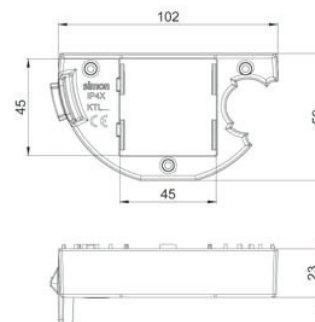

Measurements in mm

Instalación Installation Installatão

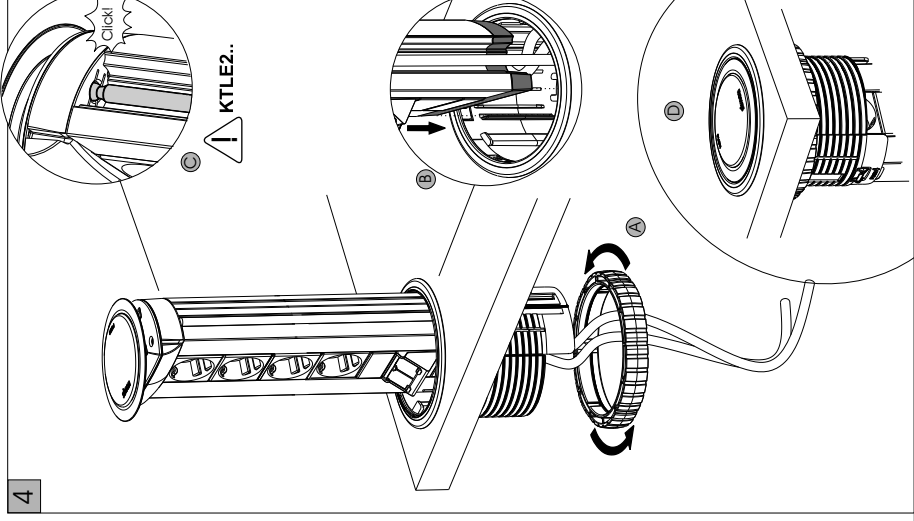
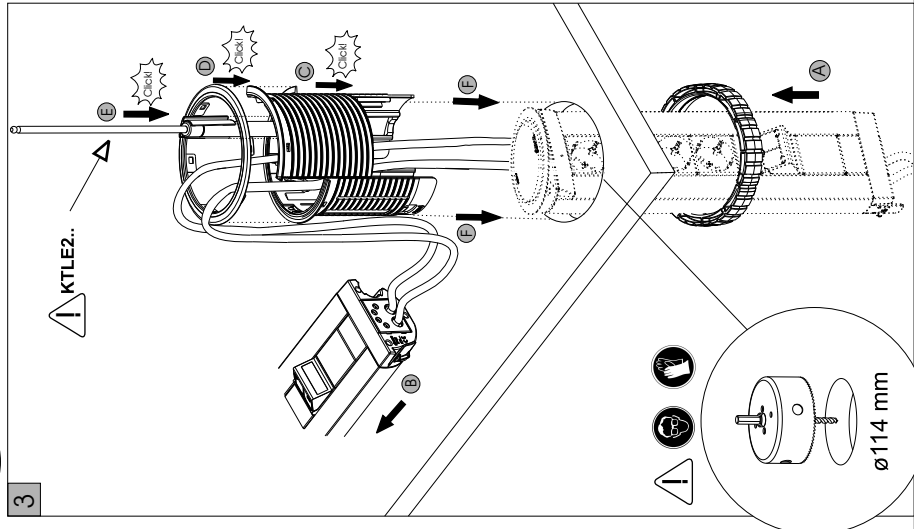
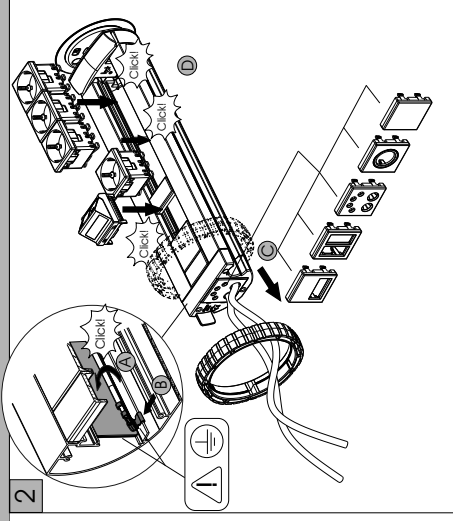
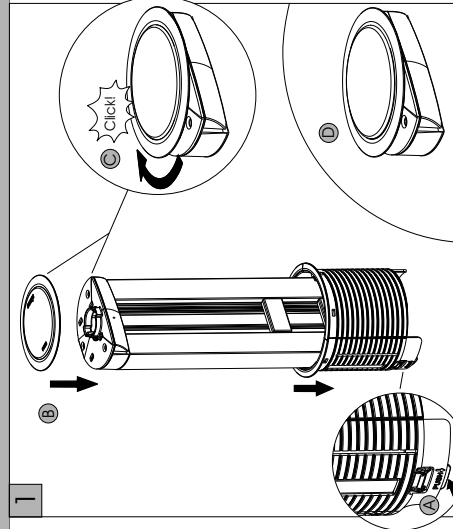

Mecanismos 45x45 no incluídos • Mechanism 45x45 not included

Funcionamiento Functioning Fonctionnement

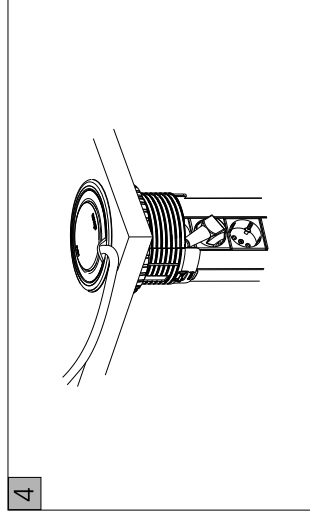
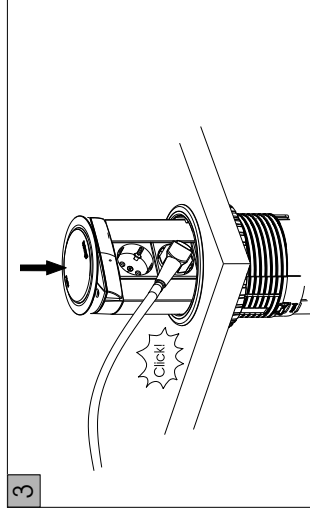
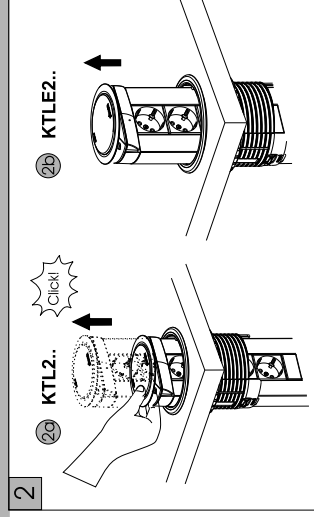
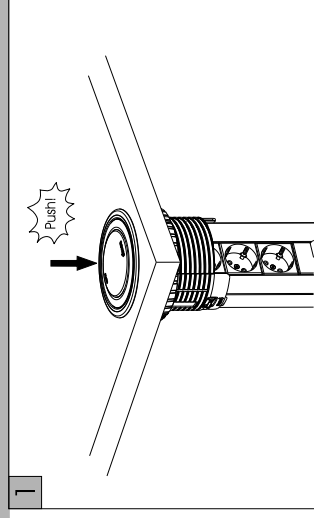

Desinstalación Uninstal Désinstallation

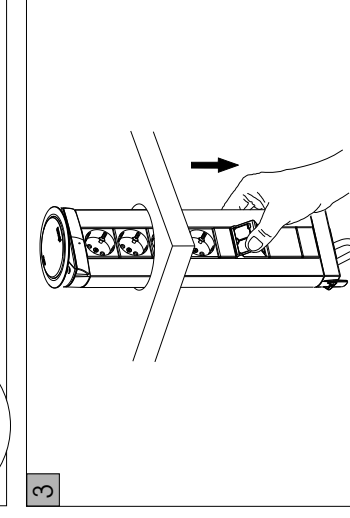
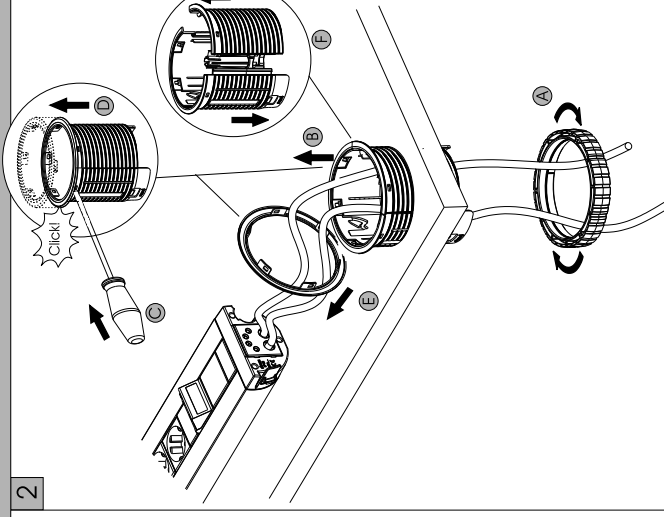
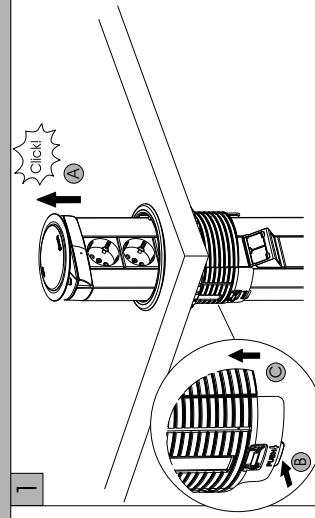

Appareillages 45x45 non inclus • Este producto é vendido sem mecanismos 45x45