



Connection Solutions
4Workplaces

simon
connect

**general
catalogue**
2011 - 2012



CIMA MINI-COLUMNS

Solutions for raised or paved floors

Top cover:
optimises the finish

Rail for fastening boxes:
allows fastening of SAL150 box

Thick aluminium section:
maximum strength

Floor trim:
covers the joints between the section and the base

Base:
allows a bolted fastening of the column to the floor

Non-slip adhesive foam:
perfect adhesion to the floor

SAL150 box: enables installation and compartmentalisation of 1 CIMA module. (Necessary for installing CIMA electrical and protection mechanisms)



The CIMA plates are installed directly on the trim frame and the inner frame.

DIN Support Guide:
prepared for installing protection elements using ref. S145
[See page 39](#)

✓ **With all necessary materials**

The CIMA Mini-column is supplied with a base, trim, end cover, fixing plugs, connection cable with earth connection, non-slip adhesive foam and all necessary hardware for installation.



Electrical sockets and plates from page 36

Aluminium	Pure white Ral 9010	Graphite grey Ral 7021	Aluminium Graphite grey Ral 7021	
/8	/9	/14	/8 /14	

COMPLETE CIMA MINI-COLUMNS (INCLUDING TRIM, BASE AND TOP COVER)



1 Face

ALC312	/8 /14	/9	2 CIMA dual modules
ALC313	/8 /14	/9	3 CIMA dual modules
ALC314	/8 /14	/9	4 CIMA dual modules
ALC315	/8 /14	/9	5 CIMA dual modules



2 Faces

ALC322	/8 /14	/9	2 CIMA dual modules per side
ALC323	/8 /14	/9	3 CIMA dual modules per side
ALC324	/8 /14	/9	4 CIMA dual modules per side
ALC325	/8 /14	/9	5 CIMA dual modules per side

CIMA mini-column spare parts



AL1110 (1 side)
AL2110 (2 sides)
Base



AL1115 /9 /14 (1 side)
AL2115 /9 /14 (2 sides)
Trim



AL3105 /9 /14 (1 side)
AL3205 /9 /14 (2 sides)
Top cover

CIMA MECHANISM ADAPTATION *



Box for CIMA socket and automatic breaker

SAL150 1 CIMA dual module



CIMA frame and inner frame

SAL100 /9 /14 /8 1 CIMA dual module

*For protection elements, DIN Guide support, ref. S145 must be used. See page 39

Mechanism housing



For white mini-columns it is advisable to install frames and mechanisms with finish /9



For dual colour mini-columns it is advisable to install frames and mechanisms with finish /14 or /8

Configuration example



	Quantity	Ref./Finish	Description
Envolvente	1	ALC313/8/14	CIMA 3-module single-side mini-column, aluminium/graphite
	3	SAL150	CIMA box for mechanisms
	3	SAL100/14	Inner frame and CIMA trim frame for box, graphite
Bases eléctricas y placas	1	S1/6/14	Two-coloured CIMA double Schuko with pilot light, red/graphite
	1	S96BU/14	CIMA Voice and Data plate with two RJ45 Cat. 6 UTP connectors, graphite
	1	SDS/14	CIMA plate with 30 mA automatic circuit-breaker, graphite
	1	S145	DIN guide adapter

Technical details
See page 155

CIMA COLUMNS
False ceiling solutions

Fastening support:
fastened by pressure to the floor slab

Telescopic guide for attachment to the floor slab:
guarantees the structural stiffness of the assembly
(1.5 metres length)

Very thick aluminium section:
section **3 metre-long** maximum
sturdiness

DIN Support Guide:
Anchoring to the box for adaptation
of protection switchgear
using ref. S145
[See page 39](#)

Pressure screw:
using the adjustment nut,
the bolt guarantees pressure

Metal separator guide:
it allows separating electrical circuits
and Voice, Data and Multimedia (VDM) circuits

SAL150 box:
Necessary for installing CIMA
electrical mechanisms

Trims:
they guarantee a perfect finish on
floors and ceilings

Non-slip adhesive foam:
perfect adhesion to the floor

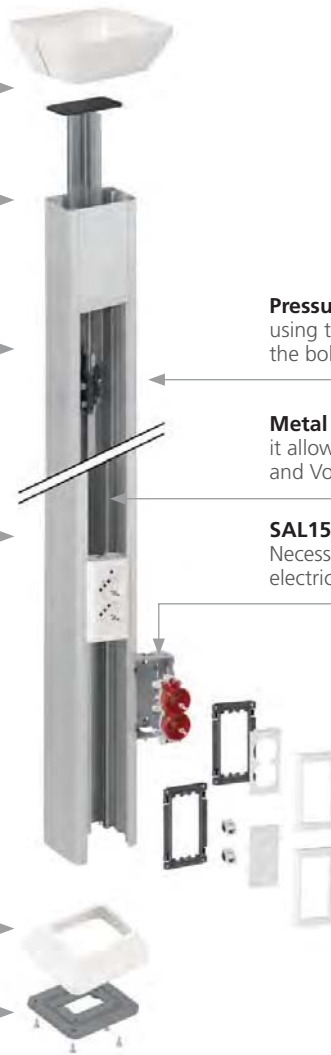

✓ **Fastening**

Easy pressure-fastening
system.

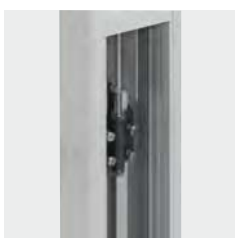

✓ **With all necessary materials**

The CIMA Column is supplied with a
base, trims, telescopic guide, support
for fixing to the ceiling, set screw, fixing
plugs, connection cable with earth
connection, non-slip adhesive foam and
all necessary hardware for installation.

[Mechanisms, electrical sockets and plates from
page 36](#)



Aluminium	Pure white Ral 9010	Graphite grey Ral 7021	Aluminium Graphite grey Ral 7021	
/8	/9	/14	/8 /14	

COMPLETE CIMA COLUMNS (INCLUDING BASE AND TRIMS FOR FLOOR AND CEILING)



1 Side

ALC3100 /8 /14 /9 CIMA Column 3 m

CIMA Column Lengthening 1 side (Includes connector pins)

0
Optional

AL31P05 /8 /9	0.5 m Lengthening
AL31P10 /8 /9	1 m Lengthening
AL31P15 /8 /9	1.5 m Lengthening



2 Sides

ALC3200 /8 /14 /9 CIMA Column 3 m

CIMA Column Lengthening 2 sides (Includes connector pins)

0
Optional

AL32P05 /8 /9	0.5 m Lengthening
AL32P10 /8 /9	1 m Lengthening
AL32P15 /8 /9	1.5 m Lengthening



Consult customised Columns in the 2010 Price List.

CIMA column
spare parts



AL1110 (1 side)
AL2110 (2 sides)
Base



AL1115 /9 /14 (1 side) **RALC001** /8 /9
AL2115 /9 /14 (2 sides) Front cover 3 m
Trim

Mechanism
housing



For dual colour columns it is
advisable to install frames
and mechanisms with finish
/14 or /8

For white columns it is
advisable to install frames
and mechanisms with finish /9

MECHANISM ADAPTATION

CIMA Mechanisms*



CIMA box for socket and
circuit-breaker

SAL150 1 CIMA dual module



CIMA frame and inner frame

SAL100 /9 /14 /8 1 CIMA dual module

Universal
Mechanisms SIMON

Universal box

0
Optional



AL50

*For protection elements, DIN Guide support ref. S145 must be used. See page 39

Configuration example



	Quantity	Ref./Finish	Description
Covering	1	ALC3100/8/14	CIMA 1 side column, aluminium/graphite
	2	SAL150	CIMA electrical mechanisms box
	3	SAL100/14	CIMA trim frame for box, graphite
Electrical sockets and plates	1	S1/6/14	Two-coloured CIMA double Schuko with pilot light, red/graphite
	1	S1/14	CIMA double Schuko with pilot light, graphite
	3	S80B96U/14	CIMA angled voice and data plate with 4 RJ45 CAT 6 UTP connectors, graphite

Technical details
See page 155

CIMA MINI-COLUMNS AND COLUMNS

- Product designed according to the Safety Requirements of Directive 2006/95/EC (Low Voltage) through standard UNE-EN-50.085.
- CE marked product.
- IP protection level: 4x.
- The recommended temperature range during installation is: -25° to + 120°C.
- The maximum temperature during construction work is + 120°C.
- Manufactured in Anodised Aluminium/Painted.

Mini-columns

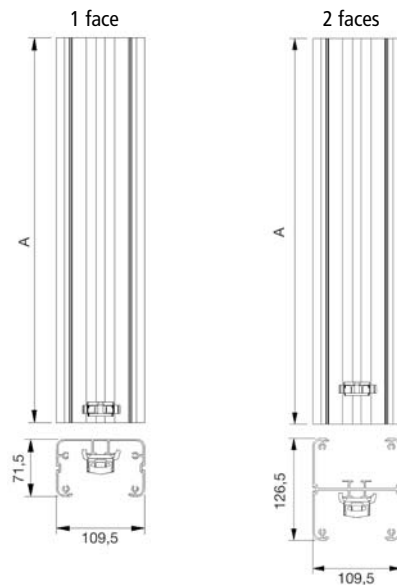

	References	No. of modules	Dimensions A
1 face	ALC312/..	2	316
	ALC313/..	3	451
	ALC314/..	4	581
	ALC315/..	5	721
2 faces	ALC322/..	4	316
	ALC323/..	6	451
	ALC324/..	8	581
	ALC325/..	10	721

Columns

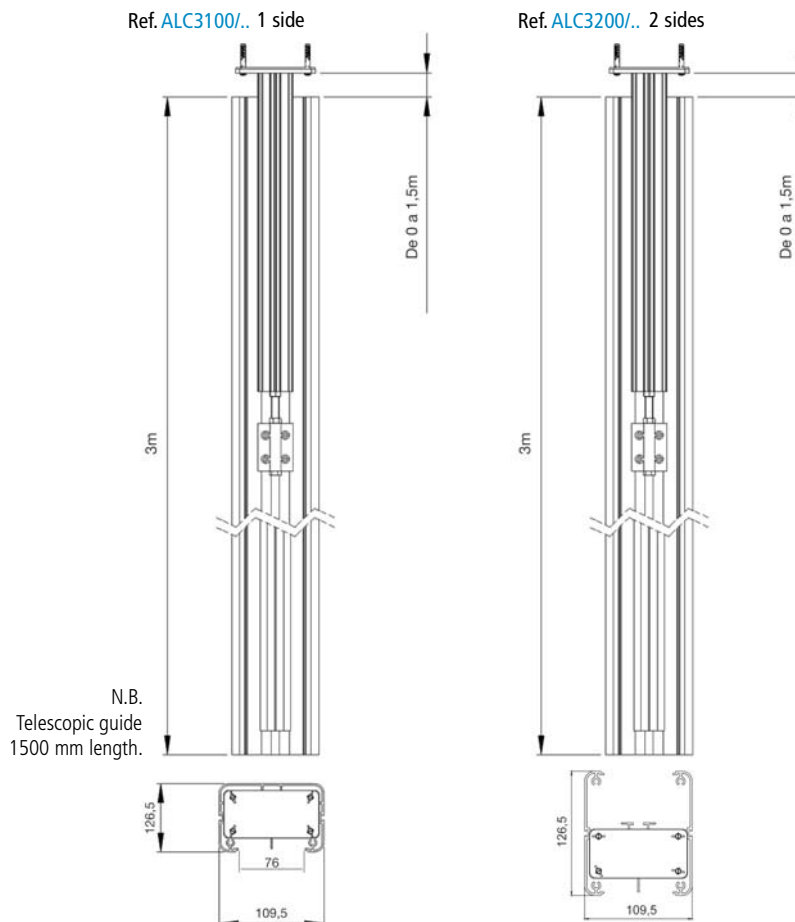

Measurements in mm

Technical information

CIMA MINI-COLUMNS AND COLUMNS

Column Extensions

Ref. [AL31Pxx/..](#)

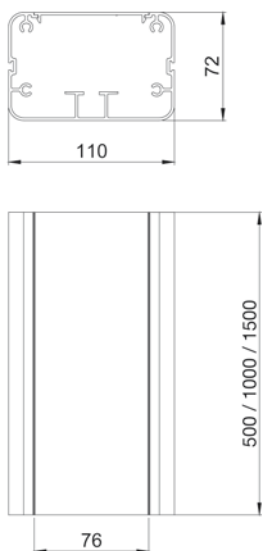

Ref. [AL32Pxx/..](#)

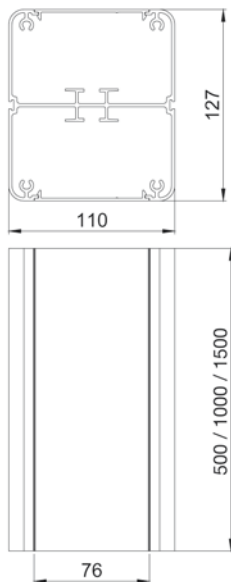

Column spare parts

Ref. [RALC001 /8 /14](#)

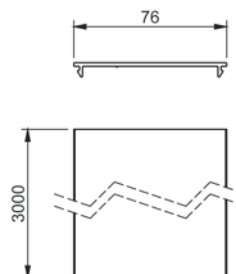

CIMA MINI-COLUMNS AND COLUMNS - SPARE PARTS

Trim

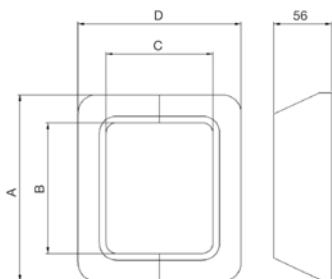

	References	Measurement A	Measurement B	Measurement C	Measurement D
1 face	AL1115/..	164.5	110	70.7	125
2 faces	AL2115/..	181	126.5	109	165

Bases

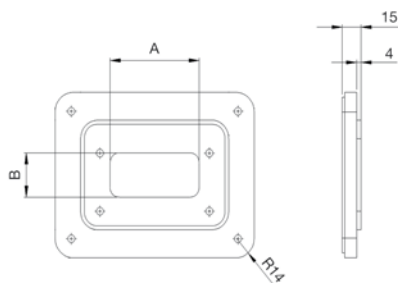

	References	Measurement A	Measurement B
1 face	AL1110	70	32
2 faces	AL2110	70	79

Top cover

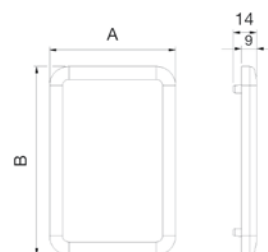

	References	Dimensions AxB
1 face	AL3105/..	75.6x113
2 faces	AL3205/..	112.8x130.8

Measurements in mm